

Zed Purlin Sleeved Systems

Performance

The performance of the systems shown in the tables below have been derived by calculation in accordance with BS 5950 Part 5. Purlin load tables are valid up to and including 25° roof slopes.

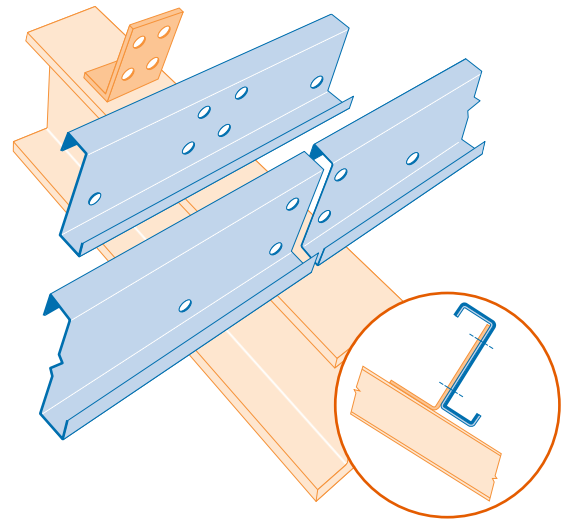

Performance

Loading	Factor
Dead load	1.40
Dead load restraining uplift or overturning	1.00
Dead load acting with wind and imposed loads combined	1.20
Imposed load	1.60
Imposed load acting with wind load	1.20
Wind load	1.40
Wind load acting with imposed load	1.20
Forces due to temperature effects	1.20
Drifting Snow	1.05

Span Metres	Section	U.D.L. kN	(Purlin Centres (mm))					Allowable Loads kN/m ²				
			1000	1200	1375	1500	1675	1800	2000	2500		
3.5	12115	11.61	3.32	2.76	2.42	2.21	1.98	1.84	1.66	1.33		
	12116	12.47	3.56	2.97	2.59	2.38	2.13	1.98	1.78	1.43		
	14015	12.57	3.59	2.99	2.61	2.39	2.14	1.99	1.80	1.44		
	14016	13.53	3.87	3.22	2.81	2.58	2.31	2.15	1.93	1.55		
	14018	14.37	4.11	3.42	2.99	2.74	2.45	2.28	2.05	1.64		
	14020	15.74	4.50	3.75	3.27	3.00	2.68	2.50	2.25	1.80		
	17715	16.04	4.58	3.82	3.33	3.05	2.74	2.55	2.29	1.83		
	17716	17.14	4.90	4.08	3.56	3.26	2.92	2.72	2.45	1.96		
	17718	19.04	5.44	4.53	3.96	3.63	3.25	3.02	2.72	2.18		
	17720	20.90	5.97	4.98	4.34	3.98	3.57	3.32	2.99	2.39		
	20018	22.93	6.55	5.46	4.76	4.37	3.91	3.64	3.28	2.62		
	20020	25.79	7.37	6.14	5.36	4.91	4.40	4.09	3.68	2.95		
20025	31.53	9.00	7.50	6.55	6.00	5.37	5.00	4.50	3.60			
4.0	12115	9.70	2.43	2.02	1.76	1.62	1.45	1.35	1.22	0.97		
	12116	10.41	2.60	2.17	1.89	1.74	1.55	1.45	1.30	1.04		
	14015	10.56	2.64	2.20	1.92	1.76	1.58	1.47	1.32	1.06		
	14016	11.37	2.84	2.37	2.07	1.90	1.70	1.58	1.42	1.14		
	14018	12.08	3.02	2.52	2.20	2.01	1.80	1.68	1.51	1.21		
	14020	13.23	3.31	2.76	2.41	2.21	1.97	1.84	1.65	1.32		
	17715	13.61	3.40	2.84	2.47	2.27	2.03	1.89	1.70	1.36		
	17716	14.54	3.64	3.03	2.64	2.42	2.17	2.02	1.82	1.45		
	17718	16.16	4.04	3.37	2.94	2.70	2.41	2.24	2.02	1.62		
	17720	17.73	4.43	3.69	3.22	2.96	2.65	2.46	2.22	1.77		
	20018	19.45	4.86	4.05	3.53	3.24	2.90	2.70	2.43	1.95		
	20020	21.88	5.47	4.56	3.98	3.65	3.27	3.04	2.74	2.19		
20025	26.75	6.69	5.57	4.86	4.46	3.98	3.71	3.34	2.68			
4.5	12115	7.67	1.70	1.42	1.24	1.14	1.02	0.95	0.85	0.68		
	12116	8.23	1.83	1.52	1.33	1.22	1.09	1.02	0.91	0.73		
	14015	9.24	2.05	1.71	1.49	1.37	1.23	1.14	1.03	0.82		
	14016	9.95	2.21	1.84	1.61	1.47	1.32	1.23	1.10	0.88		
	14018	10.57	2.35	1.96	1.71	1.57	1.40	1.30	1.17	0.94		
	14020	11.58	2.57	2.14	1.87	1.71	1.54	1.43	1.29	1.03		
	17715	12.05	2.68	2.23	1.95	1.79	1.60	1.49	1.34	1.07		
	17716	12.88	2.86	2.38	2.08	1.91	1.71	1.59	1.43	1.14		
	17718	14.31	3.18	2.65	2.31	2.12	1.90	1.77	1.59	1.27		
	17720	15.70	3.49	2.91	2.54	2.33	2.08	1.94	1.74	1.39		
	20018	16.79	3.73	3.11	2.71	2.49	2.23	2.07	1.87	1.49		
	20020	18.89	4.20	3.50	3.05	2.80	2.50	2.33	2.10	1.68		
20025	23.10	5.13	4.28	3.73	3.42	3.06	2.85	2.57	2.05			

Zed Purlin Sleeved Systems

Span Metres	Section	U.D.L. kN	(Purlin Centres (mm))				Allowable Loads kN/m ²			
			1000	1200	1375	1500	1675	1800	2000	2500
5.0	12115	6.83	1.37	1.14	0.99	0.91	0.82	0.76	0.68	0.55
	12116	7.33	1.47	1.22	1.07	0.98	0.88	0.81	0.73	0.59
	14015	8.27	1.65	1.38	1.20	1.10	0.99	0.92	0.83	0.66
	14016	8.90	1.78	1.48	1.30	1.19	1.06	0.99	0.89	0.71
	14018	9.46	1.89	1.58	1.38	1.26	1.13	1.05	0.95	0.76
	14020	10.36	2.07	1.73	1.51	1.38	1.24	1.15	1.04	0.83
	17715	10.89	2.18	1.81	1.58	1.45	1.30	1.21	1.09	0.87
	17716	11.63	2.33	1.94	1.69	1.55	1.39	1.29	1.16	0.93
	17718	12.92	2.58	2.15	1.88	1.72	1.54	1.43	1.29	1.03
	17720	14.18	2.84	2.36	2.06	1.89	1.69	1.58	1.42	1.13
	20018	14.98	3.00	2.50	2.18	2.00	1.79	1.66	1.50	1.20
	20020	16.86	3.37	2.81	2.45	2.25	2.00	1.87	1.69	1.35
20025	20.60	4.12	3.43	2.98	2.75	2.46	2.29	2.06	1.65	
5.5	14015	7.27	1.32	1.10	0.96	0.88	0.79	0.73	0.66	0.53
	14016	7.80	1.42	1.18	1.03	0.95	0.85	0.79	0.71	0.57
	14018	8.31	1.51	1.26	1.10	1.00	0.90	0.84	0.75	0.60
	14020	9.10	1.66	1.38	1.20	1.10	0.99	0.92	0.83	0.66
	17715	9.95	1.81	1.51	1.32	1.21	1.08	1.00	0.90	0.72
	17716	10.63	1.93	1.61	1.40	1.29	1.15	1.07	0.97	0.77
	17718	11.81	2.15	1.79	1.56	1.43	1.28	1.19	1.07	0.86
	17720	12.97	2.36	1.96	1.71	1.57	1.41	1.31	1.18	0.94
	20018	13.65	2.48	2.07	1.80	1.65	1.48	1.38	1.24	0.99
	20020	15.35	2.79	2.33	2.02	1.86	1.66	1.55	1.40	1.12
	20025	18.39	3.34	2.79	2.43	2.23	1.99	1.86	1.67	1.34
	6.0	14015	6.21	1.03	0.86	0.75	0.69	0.62	0.57	0.52
14016		6.68	1.11	0.93	0.81	0.74	0.66	0.62	0.56	0.45
14018		7.09	1.18	0.98	0.86	0.79	0.71	0.66	0.59	0.47
14020		7.77	1.30	1.08	0.94	0.86	0.77	0.72	0.65	0.52
17715		8.94	1.49	1.24	1.08	0.99	0.89	0.83	0.74	0.60
17716		9.54	1.59	1.33	1.16	1.06	0.95	0.88	0.79	0.63
17718		10.60	1.77	1.47	1.29	1.18	1.06	0.98	0.88	0.71
17720		11.64	1.94	1.62	1.41	1.29	1.16	1.08	0.97	0.78
20018		12.35	2.06	1.72	1.49	1.37	1.23	1.14	1.03	0.82
20020		14.05	2.34	1.95	1.70	1.56	1.39	1.30	1.17	0.94
20025		16.80	2.80	2.33	2.03	1.87	1.67	1.55	1.40	1.12
6.5		17715	7.98	1.23	1.02	0.89	0.82	0.73	0.68	0.61
	17716	8.52	1.31	1.09	0.95	0.87	0.78	0.73	0.66	0.52
	17718	9.47	1.46	1.21	1.06	0.97	0.87	0.81	0.73	0.58
	17720	10.39	1.60	1.33	1.16	1.07	0.95	0.89	0.80	0.64
	20018	11.54	1.78	1.48	1.29	1.18	1.06	0.98	0.89	0.71
	20020	12.98	2.00	1.66	1.45	1.33	1.19	1.11	1.00	0.80
	20025	15.67	2.41	2.01	1.75	1.61	1.44	1.34	1.21	0.96
7.0	20018	10.19	1.46	1.21	1.06	0.97	0.87	0.81	0.73	0.58
	20020	11.61	1.66	1.38	1.20	1.11	0.99	0.92	0.83	0.66
	20025	14.19	2.03	1.69	1.47	1.35	1.21	1.13	1.01	0.81
7.5	20020	10.11	1.35	1.12	0.98	0.90	0.80	0.75	0.67	0.54
	20025	12.36	1.65	1.37	1.20	1.10	0.98	0.92	0.82	0.66
8.0	20025	10.18	1.27	1.06	0.92	0.85	0.76	0.71	0.64	0.51
8.5	20025	8.49	1.00	0.83	0.73	0.67	0.60	0.55	0.50	0.40